



FOR SALE  
jordan fishwick  
WILMSLOW  
01625 532 000  
www.jordanfishwick.co.uk

*jordan fishwick*

65 Twinnies Road, SK9 4BT  
Guide Price £283,950





## Twinnies Road Wilmslow SK9 4BT

Guide Price £283,950



This well presented three bedroom home is situated within the Lacey Green area of Wilmslow. Locally there are good local state schools and a wide choice of private schools with the popular Lacey Green Primary Academy being very close by. Wilmslow train station, Leisure Centre and shopping facilities are nearby with fitness centres, golf courses, Marks and Spencer and John Lewis within a 10 minute drive. Internally the accommodation comprises in brief: entrance vestibule with arch leading to utility area, entrance hallway, living room, attractive and modern fitted kitchen and a dining room. The first floor comprises: three double bedrooms, a white bathroom suite and a separate W.C. To the front there is a driveway providing off road parking. To the rear there are attractive low maintenance gardens which have a paved area and mature trees , shrubs and plants, enclosed by timber fenced boundaries. Private Garden. Internal viewings are highly recommended.







- Mid Terrace property
- Three Bedrooms
- Open plan dining and kitchen area
- Off road parking
- Utility Room
- Separate bathroom and W.C
- Upvc double glazed
- Gas central heating



Energy Efficiency Rating		
	Current	Potential
Very energy efficient - lower running costs		
(92 plus) A		86
(81-91) B		
(69-80) C		
(55-68) D	58	
(39-54) E		
(21-38) F		
(1-20) G		
Not energy efficient - higher running costs		
England & Wales		EU Directive 2002/91/EC 



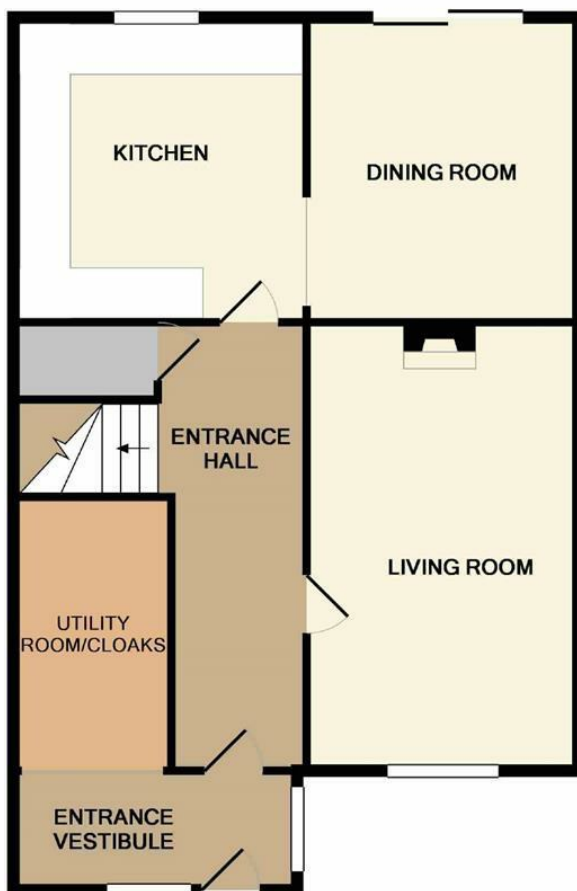

GROUND FLOOR



1ST FLOOR

Whilst every attempt has been made to ensure the accuracy of the floor plan contained here, measurements of doors, windows, rooms and any other items are approximate and no responsibility is taken for any error, omission, or mis-statement. This plan is for illustrative purposes only and should be used as such by any prospective purchaser. The services, systems and appliances shown have not been tested and no guarantee as to their operability or efficiency can be given  
Made with Metropix ©2019



These particulars are believed to be accurate but they are not guaranteed and do not form a contract. Neither Jordan Fishwick nor the vendor or lessor accept any responsibility in respect of these particulars, which are not intended to be statements or representations of fact and any intending purchaser or lessee must satisfy himself by inspection or otherwise as to the correctness of each of the statements contained in these particulars. Any floorplans on this brochure are for illustrative purposes only and are not necessarily to scale.

Offices at: Chorlton, Didsbury, Disley, Hale, Glossop, Macclesfield, Manchester Deansgate, Manchester Whitworth Street, New Mills, Sale, Wilmslow and Withington

36-38 Alderley Road, Wilmslow, Cheshire, SK9 1JX

**01625 532000**

[wilmslow@jordanfishwick.co.uk](mailto:wilmslow@jordanfishwick.co.uk)

[www.jordanfishwick.co.uk](http://www.jordanfishwick.co.uk)